

A

B

C

D

E

F

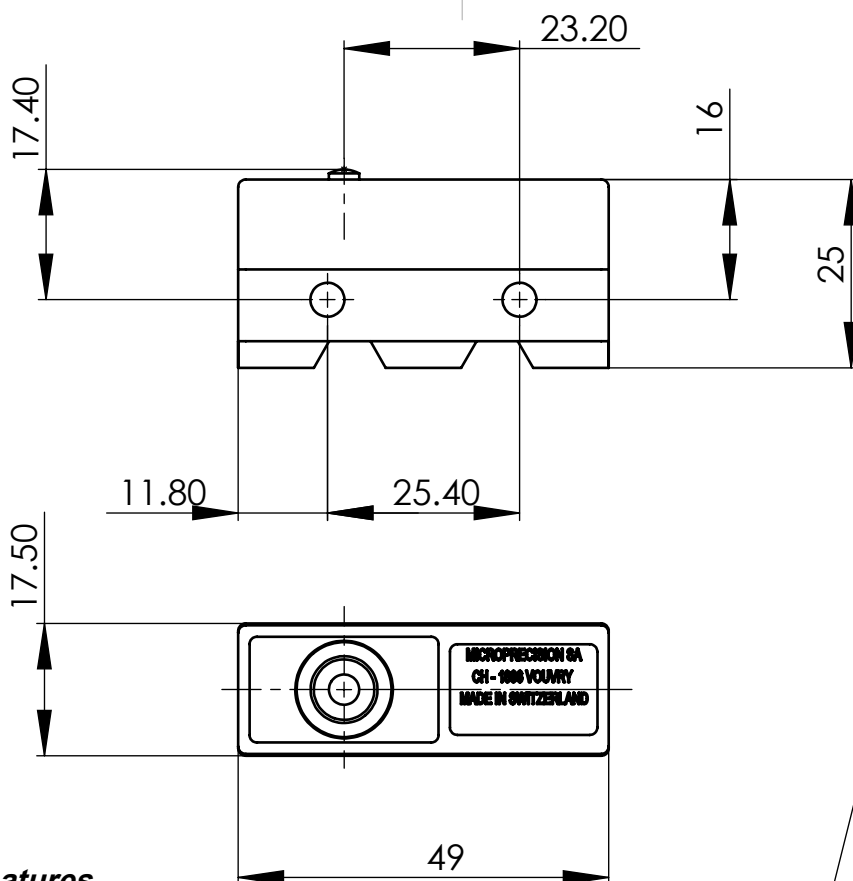

Switch features

Operating

Actuating force max	Fa (N)	5 ± 1
Release force min	Fr (N)	3
Approch travel max	sa (mm)	1.1
Overtravel min	sr (mm)	0.25
Differential movt max	sd (mm)	0.05

Other features

Mechanism Snap action spring blade

Special checking

All travels and forces checked at 100%
Contact failure at 100% (max 0.005 mm)

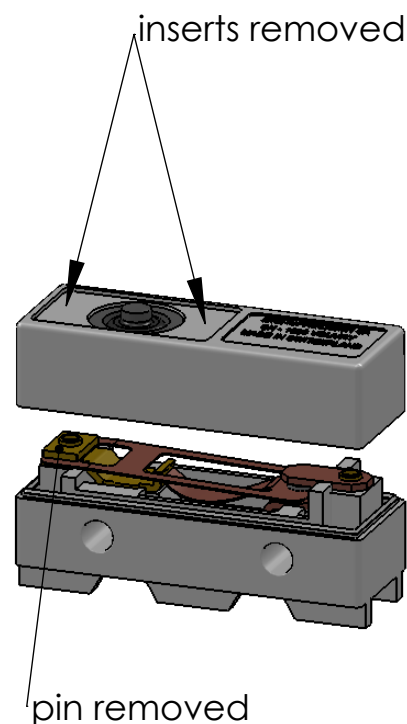

**Delivered with 2 terminal screws VIB90
NOT ASSEMBLED**

Date révision	26.10.2009	Date impression	03.11.2009
Réviseur	VCA		

Matière:	/	Tolérances générales	/
Référence article:	/	Remplace	MP90KROM1275E

Désignation MP90VI-0/KRO03	Dessiné	VCA	
	Date	26.10.2009	
	Echelle	1:1	Format A4

 MICROPRECISION ELECTRONICS SA CH - 1896 VOUVRY	N° dessin	MP90KROM1915	Rev.	F