

Dimensioni d'ingombro

Overall dimensions

Forma B14 - Grandezza 63÷100
Motori autoventilati (IC 411)

Mounting B14 - Frame size 63÷100
Self-ventilated motors (IC 411)

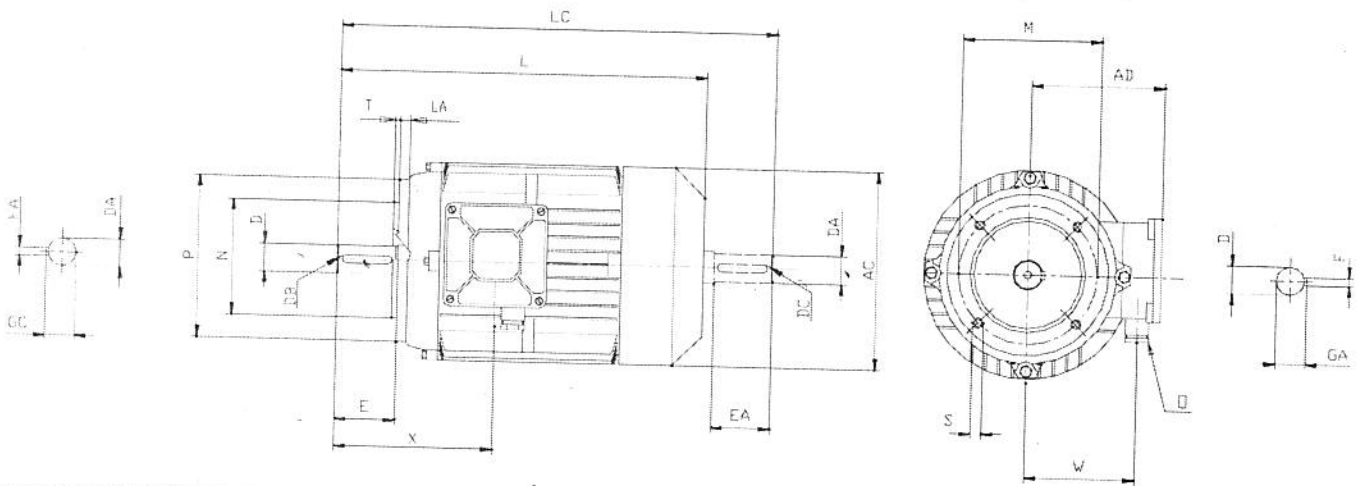

Tipo Type	Poli Poles	Dimensioni / Dimensions												
		AC	AD	L	LA	LC	M	N	P	S	T	X	W	O
63	2-4-6-8	125	95	212	8	239	75	60 j6	90	N.4xM5	2.5	86	68	M16x1.5
							85	70 j6	105	N.4xM6	2.5			
							100	80 j6	120	N.4xM6	3			
71		148	115	238	8	280	85	70 j6	105	N.4xM6	2.5	111	88	M20x1.5
							100	80 j6	120	N.4xM6	3			
							115	95 j6	140	N.4xM8	3			
80		170	126	274	8	325	85	70 j6	105	N.4xM6	2.5	113	96	M20x1.5
							100	80 j6	120	N.4xM6	3			
							115	95 j6	140	N.4xM8	3			
							130	110 j6	160	N.4xM8	3.5			
90S		185	142	297	10	374	115	95 j6	140	N.4xM8	3	134	115	M20x1.5
							130	110 j6	160	N.4xM8	3.5			
90L		185	142	322	10	399	115	95 j6	140	N.4xM8	3	134	115	M20x1.5
	130						110 j6	160	N.4xM8	3.5				
100L	210	155	361	10	430	130	110 j6	160	N.4xM8	3.5	160	123	M25x1.5	
						165	130 j6	200	N.4xM10	3.5				

Tipo Type	Poli Poles	Flangia B5 / Flange B5					Albero L.A. / DE shaft				
		D	E	F	GA	DB	DA	EA	FA	GC	DC
63	2-4-6-8	11 j6	23	4	12.5	M4x0.7	11 j6	23	4	12.5	M4x0.7
71		14 j6	30	5	16	M5x0.8	14 j6	30	5	16	M5x0.8
80		19 j6	40	6	21.5	M6x1	19 j6	40	6	21.5	M6x1
90S		24 j6	50	8	27	M8x1.25	24 j6	50	8	27	M8x1.25
90L		24 j6	50	8	27	M8x1.25	24 j6	50	8	27	M8x1.25
100L		28 j6	60	8	31	M10x1.5	28 j6	60	8	31	M10x1.5