

Migration Solutions



140-CMN to 140MG Motor Protection Circuit Breaker

140MG Motor Protection Circuit Breaker Features and Benefits

The new 140MG-H Allen-Bradley® Motor Protection Circuit Breakers are designed to offer:

- Disconnecting means for motor branch circuit protection, overload thermal protection, short-circuit magnetic protection, and manual switching
- Enhanced interrupting ratings
- Selectable trip class
- Visible trip indication
- High switching capacity
- Wide range of accessories

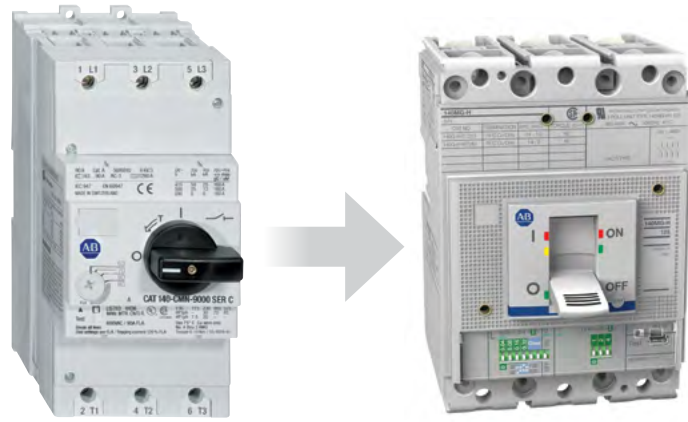

End of Life 140-CMN Motor Protection Circuit Breaker

140MG Motor Protection Circuit Breaker Migration Product

Identify, Mitigate and Eliminate the Risks of Automation Obsolescence

Bulletin 140-CMN

Bulletin 140MG, Catalog IDs 140MG-H8E*

Current Rating 16...90 A	Current Rating 10...100 A
Size (W x H x D) - 79.5 x 168 x 140.6 mm	Size (W x H x D) - 90 x 130 x 116 mm
Size (W x H x D) - 3.13 x 6.61 x 5.54 inch	Size (W x H x D) - 3.54 x 5.12 x 4.57 inch
Rotary Knob	Rocker Lever (Rotary Optional)
Connection by Lugs	Connection - Busbar (Lugs Optional)
DIN Rail Mounting Standard	Panel Mounting
IEC/EN 60947-1, -2 & UL 508 (Group Install) CSA, C22.2 No.14	High Interrupt Ratings IEC/EN 60947-1, -2 & UL 489 CSA, C22.2 No.5

For more information, consult the technical specifications and selection guide on www.ab.com

Product Lifecycle

Use the [Product Lifecycle Status](#) search tool on the web to find specific lifecycle information by catalog number.



- ACTIVE: Most current offering within a product category.
- ACTIVE MATURE: Product is fully supported, but a newer product or family exists. Gain value by migrating.
- END OF LIFE: Discontinued date announced – actively execute migrations and last time buys. Product generally orderable until the discontinued date.¹
- DISCONTINUED: New product no longer manufactured or procured.² Repair/exchange services may be available.

1 - Outages on specific items may occur prior to the Discontinued date. 2 - Limited stock may be available in run-out mode, regionally.

LISTEN.
THINK.
SOLVE.®

140-CMN Motor Protection Circuit Breaker Compared to the 140MG Motor Protection Circuit Breaker

The 140-CMN catalog numbers being discontinued are listed in the table below with a cross reference to the recommended 140MG catalog number(s). These are functional replacements and you need to select right accessories to meet functional as well as installation requirements.

Catalog Number Migration

140-CMN	140MG-H8E*	140M
140-CMN-2500	140MG-H8E-C25	140M-D8E-C25 /140M-F8E-C25
140-CMN-4000	140MG-H8E-C60	140M-F8E-C45
140-CMN-6300	140MG-H8E-C60	
140-CMN-9000	140MG-H8E-D10	



Direct Rotary Operator

Handle Color	Cat. No.
Black	140G-H-RMB
Red / Yellow	140G-H-RMY

140-CMN	140MG-H8E*
140-CA20	140G-H-EA2B
140-CA02	140G-H-EA2B
140-CA11	140G-H-EA2B
140-CT10-10	140G-H-EA1R1B
140-CT01-01	140G-H-EA1R1B
140-CT01-10	140G-H-EA1R1B
140-CT10-01	140G-H-EA1R1B
140-CUV-KJ	140G-G-UVJ
140-CUV-D	140G-G-UVD
140-CUV-A	140G-G-UVA
140-CRT-KJ	140G-G-SNJ
140-CRT-D	140G-G-SND
140-CRT-A	140G-G-SNA
140-KN	140G-H-RMB
140-KRY	140G-H-RMY
140-CDN66	140U-PB
140-CDRY66	140U-PY



Terminal Lugs

Description	Cat. No. (Pkg. Qty. 3)	Cat. No. (Pkg. Qty. 4)
Cu wire only (1) 14...1/0 AWG or 2.5...95 mm ²	140G-H-TLC13	140G-H-TLC14
Multiple cable - Cu wire (6) 14...2 AWG or 2.5...35 mm ²	140G-H-MTL63	140G-H-MTL64

Extended terminal and spreader terminals are also available.



Variable Depth Rotary Operating Kits

Handle Color	Shaft Length	Cat. No.
Black	12 in. (30.48 mm)	140G-H-RVM12B
Red / Yellow	12 in. (30.48 mm)	140G-H-RVM12R
Black	21 in. (53.34 mm)	140G-H-RVM21B
Red / Yellow	21 in. (53.34 mm)	140G-H-RVM21R

Bulletin 140MG Dimensions

Dimensions are in millimeters. Dimensions are not intended to be used for manufacturing purposes.

Panel Mounted Molded Case Circuit Breaker

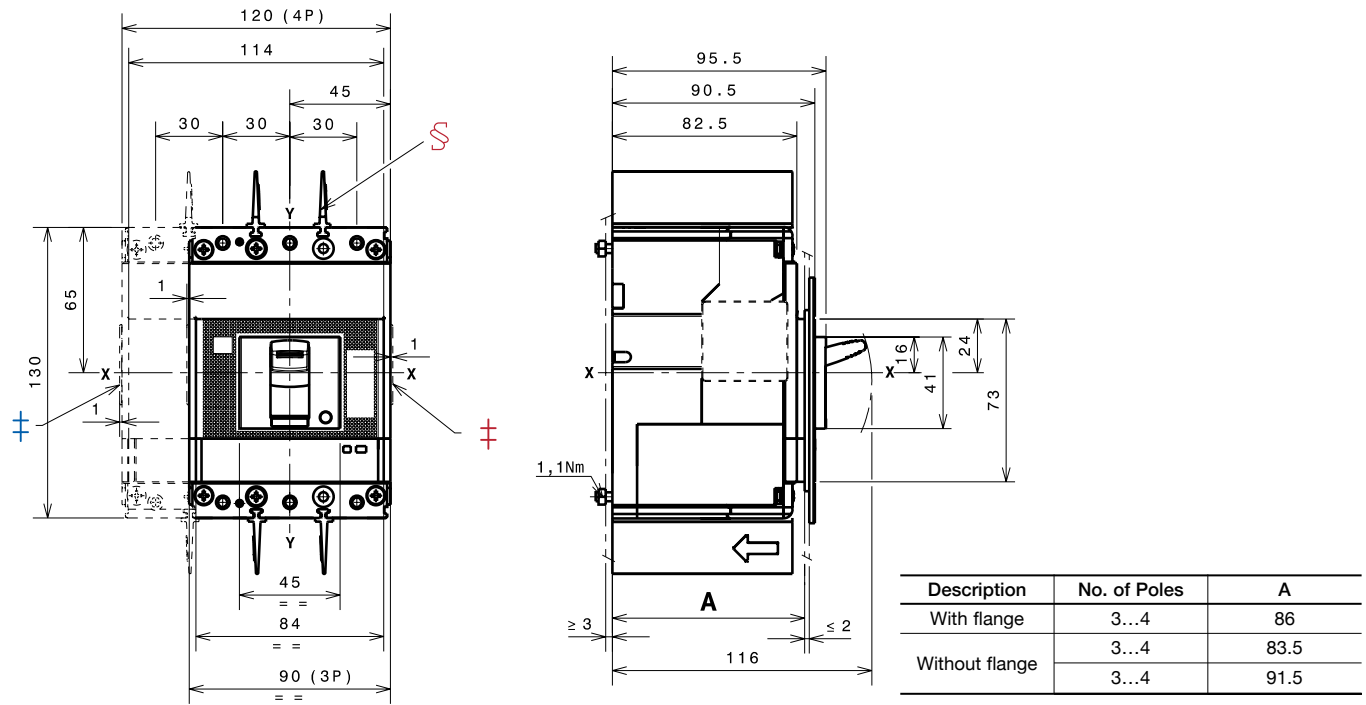

- ‡ Overall dimensions of optional wiring ducts
- § Required 25 mm insulating phase barriers provided

Allen-Bradley and Listen. Think. Solve. are trademarks of Rockwell Automation, Inc.
Trademarks not belonging to Rockwell Automation are property of their respective companies.

www.rockwellautomation.com

Power, Control and Information Solutions Headquarters

Americas: Rockwell Automation, 1201 South Second Street, Milwaukee, WI 53204-2496 USA, Tel: (1) 414.382.2000, Fax: (1) 414.382.4444

Europe/Middle East/Africa: Rockwell Automation NV, Pegasus Park, De Kleetlaan 12a, 1831 Diegem, Belgium, Tel: (32) 2 663 0600, Fax: (32) 2 663 0640

Asia Pacific: Rockwell Automation, Level 14, Core F, Cyberport 3, 100 Cyberport Road, Hong Kong, Tel: (852) 2887 4788, Fax: (852) 2508 1846